



KEY INFORMATION:

- the only enclosed regional shopping and entertainment destination in the Greater Fredericton Region
- one of New Brunswick’s largest shopping centres with over 100 shops and services
- wide array of top caliber brands, a ten-screen movie theatre, and a 14 outlet food court
- Approximate GLA: 504,987 square feet
- CRU Productivity: \$579 psf (Dec 2019)

LOCATION:

- 1381 Regent Street, Fredericton, New Brunswick
- located in the centre of Fredericton’s retail district and easily accessible from major traffic arteries
- Regent Mall remains the market leader, and is the centre of choice for consumers in the area
- located within 5 minutes of Dr. Everett Chalmers Regional Hospital and adjacent to the Fredericton Inn

MARKET:

- 96,874 residents in primary trade area (PTA)
- PTA is within a 25 km radius
- 167,000 residents in total trade area
- three levels of government, two major Universities, and the Canadian Forces Base Gagetown are all within the PTA

For a complete list of retailers and hours of operation, please visit the Centre’s website at www.regentmall.com

REGENT MALL IS ANCHORED BY:



Leasing Contact:
 Craig McLellan, Director, Leasing
 647.258.3675 | cmclellan@primarisreit.com

Centre Contact:
 David Greene, General Manager
 506.462.0351 | dgreene@primarisreit.com

Kiosk/Cart Rental Contact:
 Clark Smith, Specialty Leasing Manager
 506.462.0354 | clarksmith@primarisreit.com



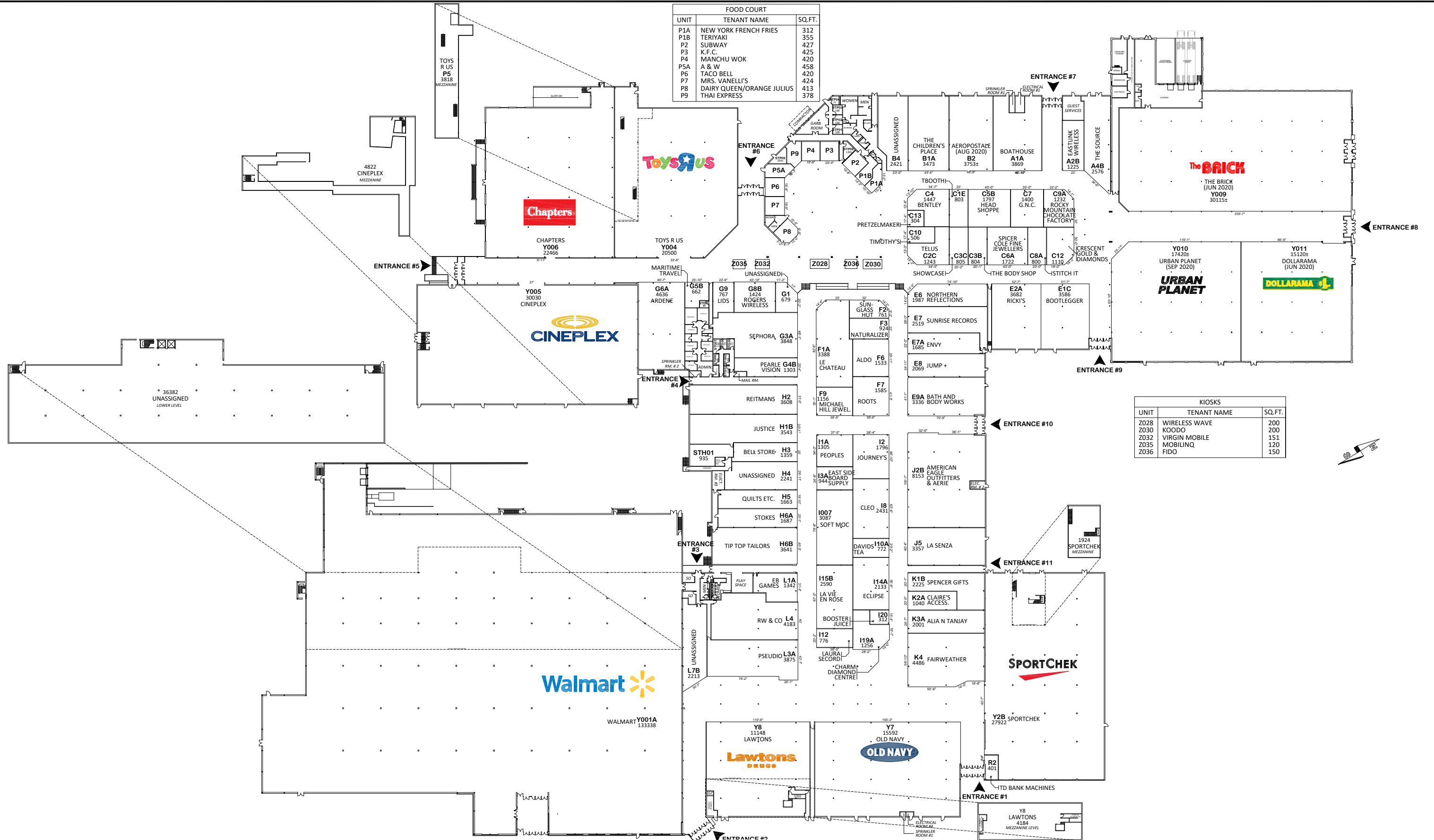

| FOOD COURT | | |
|------------|---------------------------|--------|
| UNIT | TENANT NAME | SQ.FT. |
| P1A | NEW YORK FRENCH FRIES | 312 |
| P1B | TERIYAKI | 355 |
| P2 | SUBWAY | 427 |
| P3 | K.F.C. | 425 |
| P4 | MANCHU WOK | 420 |
| P5A | A & W | 458 |
| P6 | TACO BELL | 420 |
| P7 | MRS. VANELLI'S | 424 |
| P8 | DAIRY QUEEN/ORANGE JULIUS | 413 |
| P9 | THAI EXPRESS | 378 |

| KIOSKS | | |
|--------|---------------|--------|
| UNIT | TENANT NAME | SQ.FT. |
| Z028 | WIRELESS WAVE | 200 |
| Z030 | KOODO | 200 |
| Z032 | VIRGIN MOBILE | 151 |
| Z035 | MOBILINQ | 120 |
| Z036 | FIDO | 150 |

floor plan - main level

Primaris * September 28, 2020

The Purpose of this plan is to identify the approximate location, size and dimension of the Lease premises in the Shopping Centre. The Landlord reserves the right at anytime to relocate, rearrange or alter the buildings and structures, other leased premises, and Common Area and Facilities, and the Lease Premises from that shown on the plan. All information, dimensions, sizes and areas are approximate only and are to be verified on site. In-premises washroom locations are subject to verification.

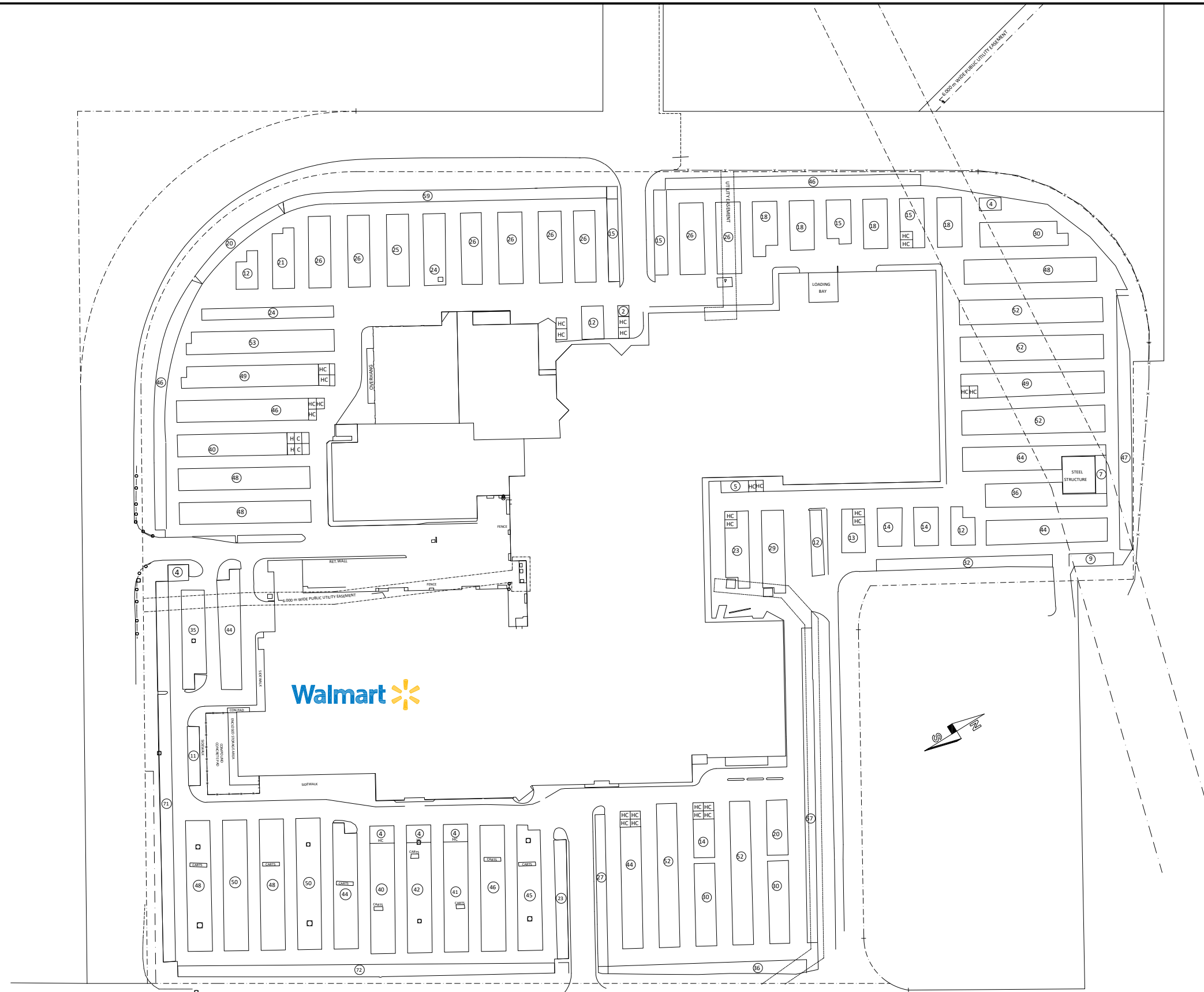

site plan

Primaris * September 28, 2020

The Purpose of this plan is to identify the approximate location, size and dimension of the Lease premises in the Shopping Centre. The Landlord reserves the right at anytime to relocate, rearrange or alter the buildings and structures, other leased premises, and Common Area and Facilities, and the Lease Premises from that shown on the plan. All information, dimensions, sizes and areas are approximate only and are to be verified on site. In-premises washroom locations are subject to verification.